

OPERATOR'S MANUAL

INCLUDING: OPERATION, INSTALLATION & MAINTENANCE

614304-B

614305-B

RELEASED: 10-23-90
REVISED: 6-21-10
(REV. B) IPP/PSE

OPEN TYPE HOSE REEL

TWO UPRIGHT, DOUBLE SWIVEL
MEDIUM PRESSURE

3000 PSI (207 bar) MAX. WORKING PRESSURE

**IMPORTANT: READ THIS MANUAL CAREFULLY BEFORE INSTALLING,
OPERATING OR SERVICING THIS EQUIPMENT.**

614304-B

Includes Roller Bracket and Reel Stop Asm.

SPECIFICATIONS

Material Inlet size	1/2"NPT-Male
Hose Connection (Outlet) Size	1/2"NPT-Female
Hose Receiver Hub Dia.	9"(229 mm)
Hose Receiver O.D. Dia.	19"(438 mm)
Hose Receiver Width	3"(76 mm)
Overall Height	26.187"(665 mm)
Swivel Pressure Max. Cap	3000 PSI (207 bar)
Capacity (Hose)	TWO-25', 1/2" ID Wire Braid Hose
Service Kit Available	637036-B

614305-B

No Roller Bracket or Stop

SPECIFICATIONS

Material Inlet size	3/4"NPT-Female
Hose Connection (Outlet) Size	3/4"NPT-Female
Hose Receiver Hub Dia.	9"(229 mm)
Hose Receiver O.D. Dia.	19"(438 mm)
Hose Receiver Width	3"(76 mm)
Overall Height	21.125"(536 mm)
Swivel Pressure Max. Cap	3000 PSI (207 bar)
Service Kit Available	637036-B

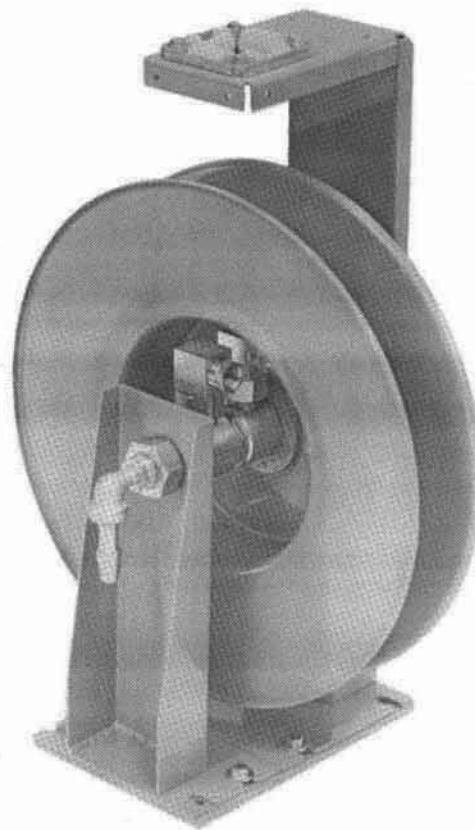

INGERSOLL RAND COMPANY LTD

209 NORTH MAIN STREET – BRYAN, OHIO 43506

☎ (800) 495-0276 • FAX (800) 892-6276

www.ingersollrandproducts.com

© 2010

ARO

IR Ingersoll Rand
Industrial Technologies

OPERATING AND SAFETY PRECAUTIONS

DO NOT EXCEED MAXIMUM WORKING PRESSURE

- HEED ALL WARNINGS.
- Use ARO replacement parts to assure compatible pressure rating.
- **WARNING: SYSTEM PRESSURE LIMITS.** System pressure should never exceed the maximum working pressure of any component or accessory used in the system.
- **WARNING: INJECTION HAZARD.** NEVER ALLOW PRESSURIZED MATERIAL, FLUIDS, OR AIR TO BE DIRECTED TOWARDS THE SKIN.
- **WARNING: SPRING UNDER TENSION.** Be extremely careful when working on a reel when the spring is under tension, be certain to take all precautions necessary to insure safety.

OPERATING INSTRUCTIONS

- When pulling hose from reel, pull on hose itself, not on control handle or swivel.
- When hose is withdrawn from reel as far as possible, do not continue to pull or jerk in order to gain an extra inch.
- To catch hose in extended position, pull out to desired length and then let retract slowly until it catches.
- To retract hose back on to the reel, let it go back rapidly until only a few feet remain out, then slow it down. Do not permit hose to bang back onto the reel.

SERVICE INSTRUCTIONS

NOTE: Refer to parts list pages 4 & 5 for parts shown "()".

ADJUSTING TENSION ON HOSE

To Increase tension:

- ___ Pull four or five wraps of hose out of reel.
- ___ Engage stop dog in position.
- ___ Put wraps back on reel with reel in stationary position until desired tension is obtained.

To relieve tension:

- ___ Engage stop dog in position.
- ___ Remove wraps of hose with reel in stationary position until desired tension is obtained.
- ___ Adjust hose stop to desired length.

ADJUSTING STOP DOG TENSION

- The Stop Dog is the mechanism which allows the hose to be unwound from the reel to any desired length and locked in position while it is used.
- If stop dog will not catch, more tension is required on it.

To Increase tension on the Stop Dog: Refer to parts view page 5.

- ___ Loosen (41) nut, turn (40) screw **CLOCKWISE TO INCREASE** spring tension until Stop Dog is held lightly against the spring cage.
- ___ Increase tension until the Stop Dog action is satisfactory.
- ___ If the Stop Dog catches too often and will not allow the hose to rewind freely, the tension on it should be decreased.

To decrease tension on the Stop Dog:

- ___ Follow the above procedure, except turn (40) screw **COUNTER-CLOCKWISE TO DECREASE** spring tension on the Stop Dog.
- ___ Retighten the (41) nut to secure the screw in position.

HOSE REPLACEMENT

- See pages 4 & 5.

CAUTION: RELIEVE ALL PRESSURE FROM SYSTEM

- ___ Pull hose out as far as possible and lock securely into position with stop dog.
- ___ Remove U-bolt, spacers, and nuts which retain the hose.
- ___ Unthread hose from coupling.
- ___ To install new hose, reverse the above procedure leaving a little slack between the swivel and the hose clamp.

NOTE: Use PTFE tape on the threads upon assembly.

CAUTION: Tighten hose clamp securely so the pull is on the hose clamp and not on the swivel nut. DO NOT tighten so tightly that the hose I.D. is collapsed.

LUBRICATION

When it is necessary to remove the swivel from the reel, repack the swivel with a good grade of moly-type bearing grease.

COMMON PARTS LIST

REF. DESCRIPTION	614304-B PART NO. (QTY)	614305-B PART NO. (QTY)
1 Screw	Y334-108-C (4)	Not Used
2 Roller, Nylon	78159-1 (4)	Not Used
3 Roller Pin	77711-1 (2)	Not Used
4 Roller	74038-1 (2)	Not Used
5 Roller Plate	77720-1 (1)	Not Used
6 Nut	Y12-4-C (8)	Y12-4-C (8)
7 Washer	Y117-416 (6)	Y117-416 (6)
8 Cage Service Asm.	61973-3 (1)	61973-2 (1)
9 Arm Asm.	61979-1 (1)	Not Used
10 Spacer	71800 (2)	71800 (2)
11 Washer	Y14-416-C (3)	Y14-416-C (2)
12 Screw	Y61-410-C (2)	Y61-410-C (2)
13 Nut	Y12-106-C (9)	Y12-106-C (9)
14 Screw	4543 (1)	4543 (1)
15 Hub Asm.	60762 (1)	60762 (1)
16 Shaft	76888-1 (1)	76888-1 (1)
17 Bracket Asm.	71829-1 (1)	Not Used
18 Screw	Y6-51-C (8)	Not Used
19 Stand Asm.	61377 (1)	61377-1 (1)
20 Stop Dog	73337 (1)	Not Used
21 Shaft	77195-1 (1)	Not Used
22 Washer	Y14-816-C (1)	Not Used
23 Nut	Y11-108-C (1)	Not Used
24 Washer	29538 (1)	Not Used
25 Ring	Y145-8 (1)	Not Used
26 Screw	Y6-62-C (4)	Y6-62-C (4)

REF. DESCRIPTION	614304-B PART NO. (QTY)	614305-B PART NO. (QTY)
27 Washer	77210 (8)	77210 (8)
28 Receiver Asm.	61747 (1)	61747 (1)
29 Adapter	71964 (2)	Not Used
30 Elbow	Y43-203-C (2)	Not Used
31 Bushing	Y45-108-C (2)	Not Used
32 Bushing	Y45-109-C (2)	Not Used
33 Stand Asm.	61868 (1)	61868 (1)
34 Plate	77209 (1)	77209 (1)
35 Spring	79126-1 (1)	Not Used
36 E-Ring	Y180-18 (1)	Not Used
37 Link	70709 (1)	Not Used
38 Washer	91089 (1)	Not Used
39 Link Nut	77727-1 (1)	Not Used
40 Screw	Y197-158-C (1)	Not Used
41 Nut	Y12-104-C (1)	Not Used
THE FOLLOWING PARTS RETAIN THE HOSE, NOT SHOWN		
42 U-Bolt	76565 (1)	76565 (1)
43 Washer	Y13-4-C (2)	Y13-4-C (2)
44 Nut	Y107-4-Z (2)	Y107-4-Z (2)
THE FOLLOWING ARE INCLUDED BUT NOT SHOWN		
Screw	Y6-65-C (8)	Y6-65-C (8)
Nut	Y12-106-C (8)	Y12-106-C (8)
Washer	77210 (4)	77210 (4)
Union	4566 (2)	Not Used
Tube Asm.	70424 (2)	Not Used

REEL DISASSEMBLY AND ASSEMBLY

RELIEVE ALL PRESSURE FROM SYSTEM

- Remove hose stop and let reel unwind slowly and carefully to relieve all spring tension.
- Remove nuts, washers, and "U" bolt, to allow unthreading of hose from hose coupling.
- Remove swivel from swivel body.
- Remove (6) nuts and remove (8) spring cage service asm. from receiver.

WARNING: DO NOT ATTEMPT TO REPLACE THE SPRING

SEPARATELY. An unleashed spring can be hazardous. A replacement spring is available only in a spring cage asm. for safety. NOTE: See page 6 for Disassembly of Swivel Section.

REEL ASSEMBLY

- Reassemble in reverse order.
- Align spring and cage asm. with hose receiver with outside loop over pin and other end through slot in hub as shown on decal on reel stand.

614305-B

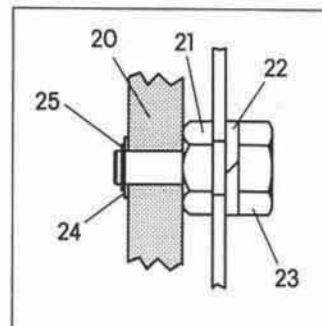

SWIVEL DETAIL VIEW

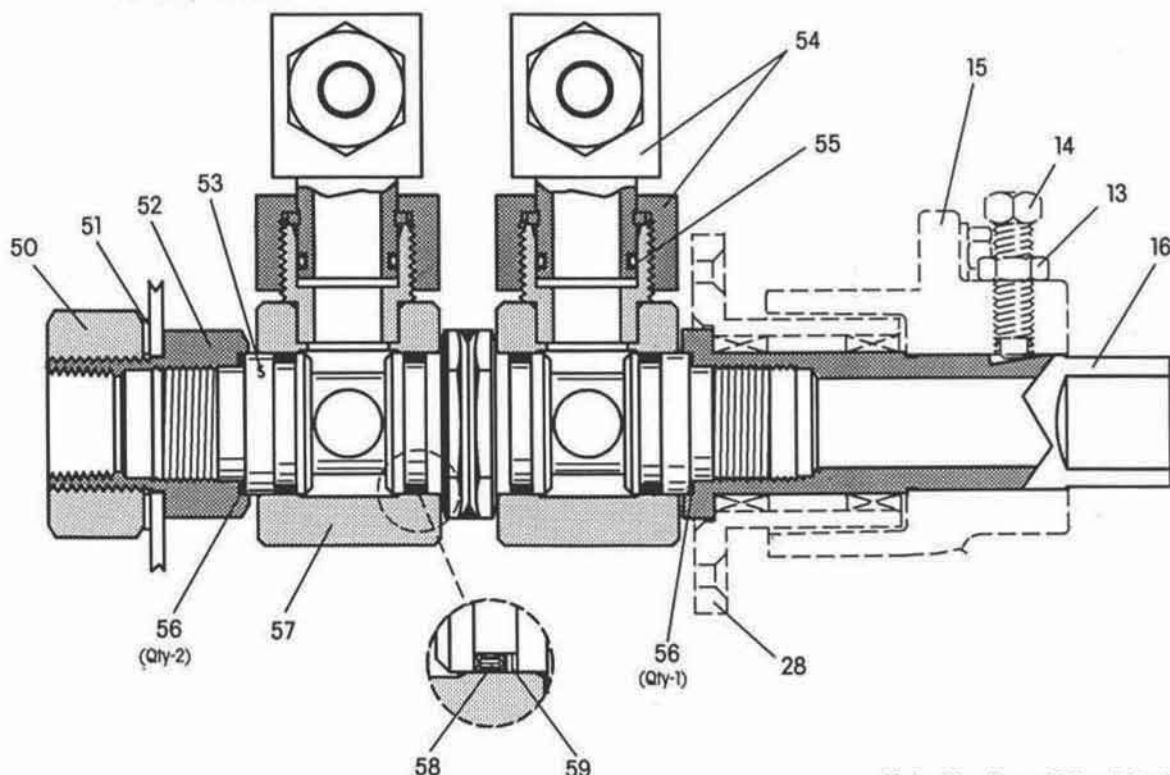

Note: See Page 3 for (13)-(28)

REF. DESCRIPTION	(QTY)	PART NO.
50 Nut	(1)	76892
51 Washer	(1)	Y1-971
52 Bearing Stud	(1)	76891-1
53 Weld Asm.	(1)	61743
54 Adapter	(2)	61744

REF. DESCRIPTION	(QTY)	PART NO.
✓ 55 O-Ring	(2)	Y325-116
✓ 56 Gasket	(3)	76890
57 Swivel Asm.	(2)	61745
✓ 58 Quad Ring	(4)	92103
✓ 59 Spiral Backup Ring (PTFE)	(4)	92107
✓ Parts Included in 637036-B Service Kit.		

SWIVEL ASSEMBLY SERVICE

Service Note: Inspect parts which have been removed for wear or damage and replace as needed.

NOTES:

1. Presoak the packings in 30 Wt. oil before assembly.
 2. Be sure the spring is in proper alignment when reinstalling.
 3. Note the location of (58) & (59). The (59) spiral rings are located to the outside of the swivel. (See detail)
- CAUTION:** Do not roll the "O" ring over sharp edges such as threads, which may damage the "O" ring. Cover any sharp edges with tape or paper and carefully slide the "O" ring into position.

OPEN STYLE REEL DIMENSIONAL DATA

Reel Model 614304-B (only) is shipped in Position "A", to change Arm Angle remove (18) screws, move to Position "B" or "C" and replace screws.

- The discharge support arm angle must be adjusted to avoid sharp bending of the hose.
- Models with exposed arm may be mounted on the floor, ceiling, or side wall.

614304-B

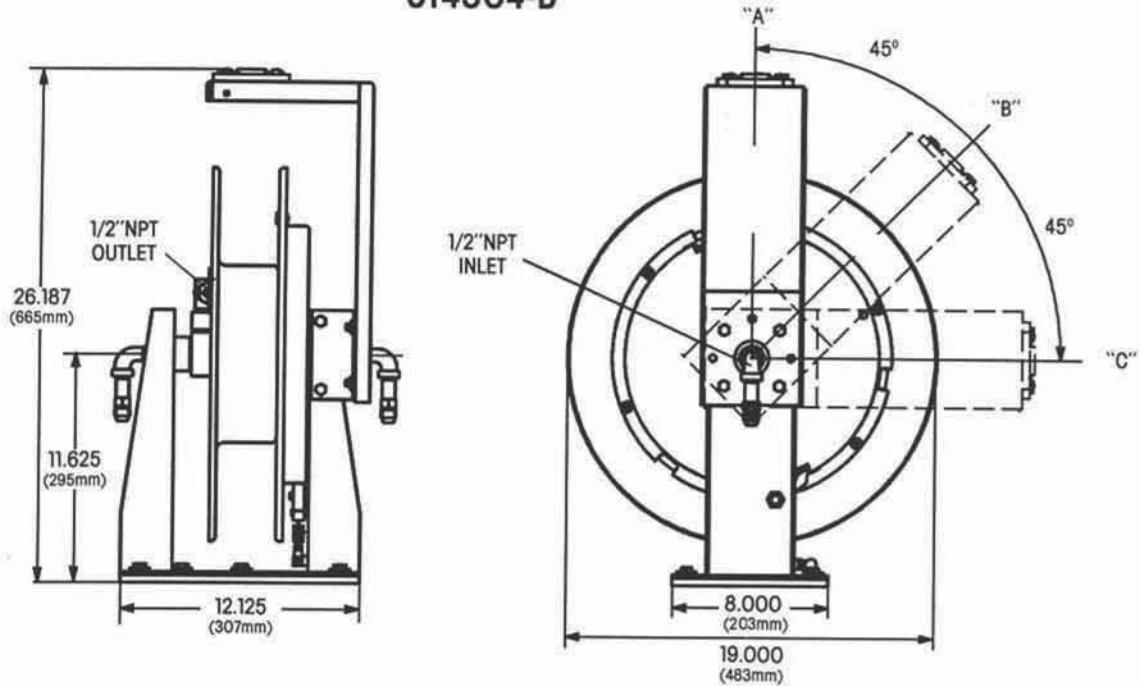

614305-B

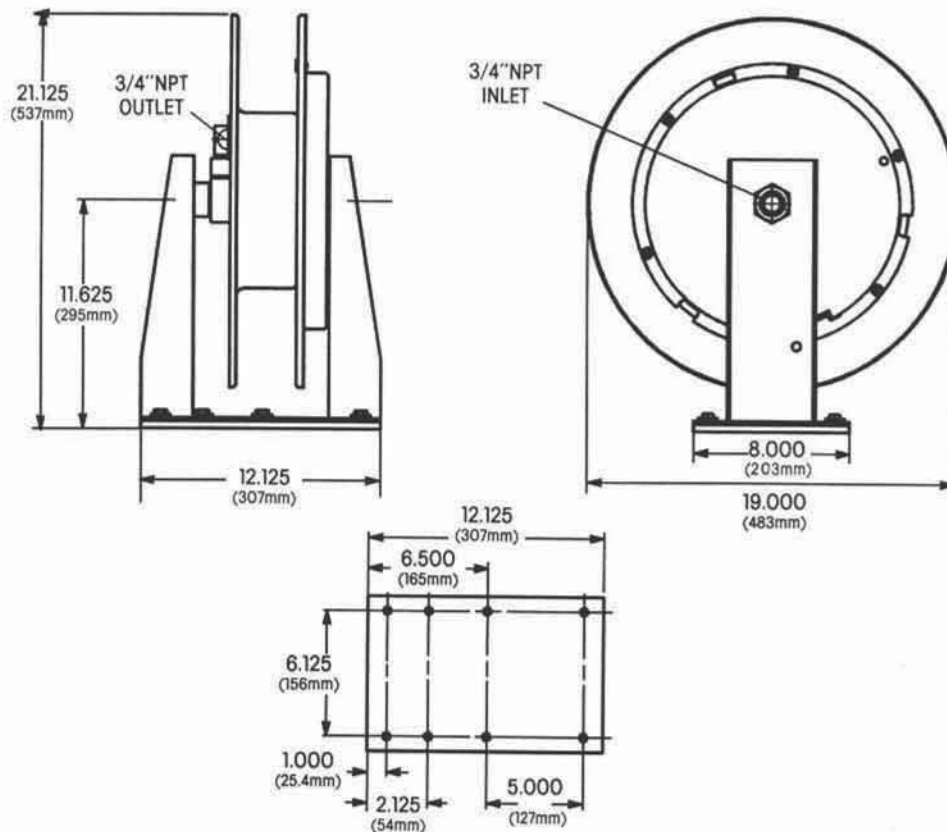

ARO

IR Ingersoll Rand
Industrial Technologies

97999-317
